

LEGEND

- TOWN LINE
- LAKE, POND, STREAM
- ADJACENT MAP **2**
- EASEMENTS
- LOT-SUB LOT **3-1**
- ADJACENT MAP LOT LINES
- UTILITY TRANSMISSION LINE

NOTE

THIS MAP IS BASED UPON A COMPILATION OF SCANNED IMAGES OF TAX MAPS UPDATED THROUGH 1999 AND SUBDIVISION PLANS 2000-MID 2004. THE MAP PLACEMENT AND LOCATION IS BASED UPON USGS QUADRANGLES AND SOME GPS MONUMENT LOCATIONS. THEREFORE, SOME DISTORTION IN SCALE AND SHAPE HAS OCCURRED. THIS MAP SHOULD NOT BE USED FOR ANY BOUNDARY OR DEED DESCRIPTIONS.

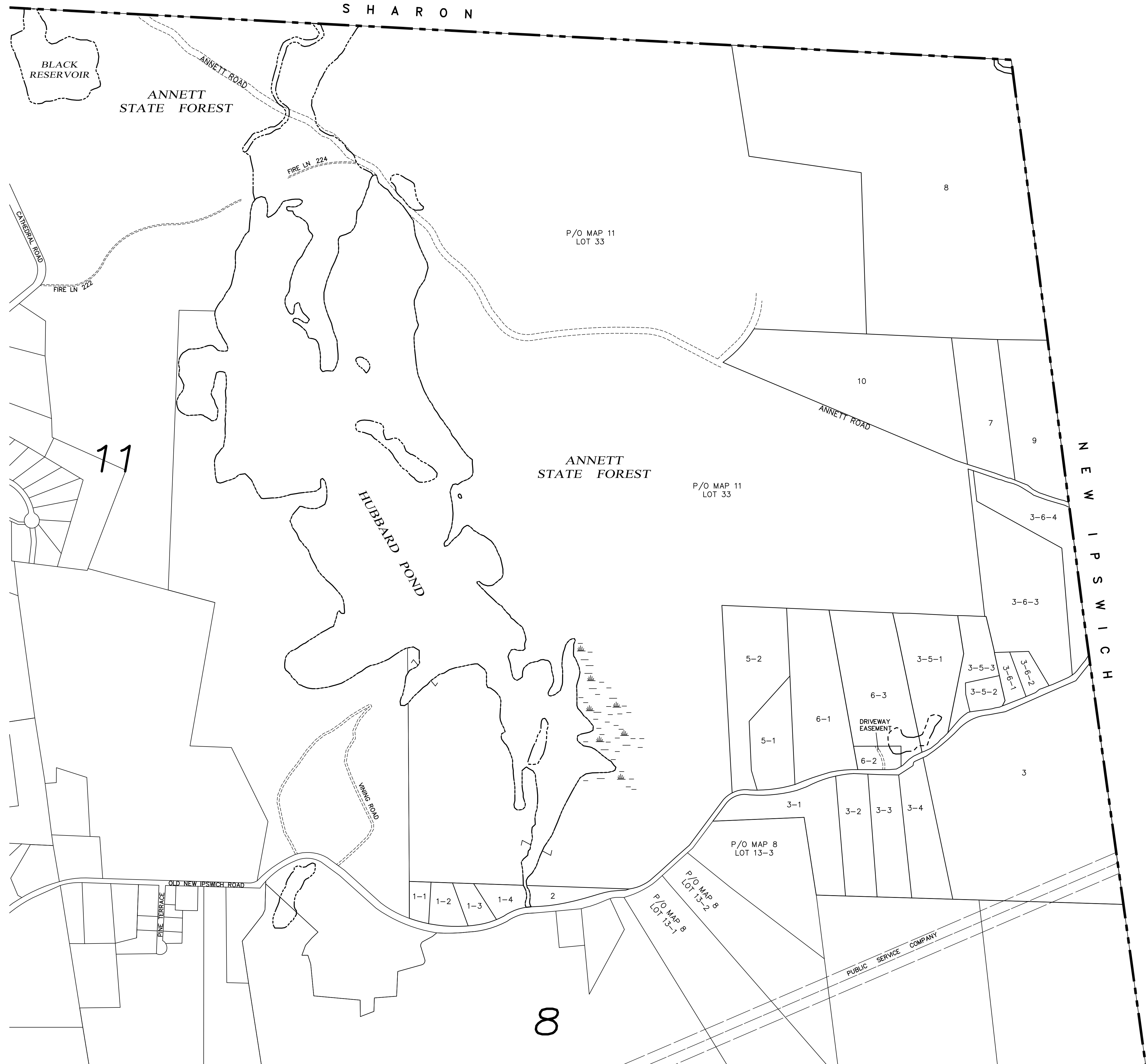

48 Constitution Drive
Bedford, NH 03110
Phone (603) 472-4488
Fax (603) 472-9747
www.tfmoran.com

Civil Engineers
Structural Engineers
Traffic Engineers
Land Surveyors
Land Planners
Landscape Architects

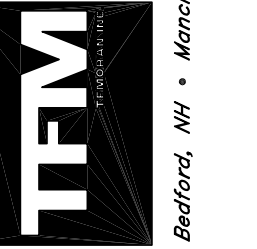

**TOWN OF RINDGE
CHESHIRE COUNTY
NEW HAMPSHIRE**

DATED: August 2004
REVISED: April 2005
 June 2005
CURRENT TO:
 APRIL 1, 2014

SCALE: 1"=500'±
CADFILE: 82290 base

PROPERTY
MAP
12