



LEGEND

TOWN LINE 

LAKE, POND, STREAM 

ADJACENT MAP **2**

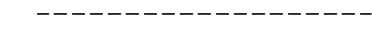
EASEMENTS 

LOT-SUB LOT 3-1

ADJACENT MAP LOT LINES 

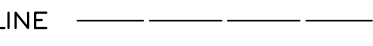
UTILITY TRANSMISSION LINE 

NOTE

THIS MAP IS BASED UPON A COMPILATION OF SCANNED IMAGES OF TAX MAPS UPDATED THROUGH 1999 AND SUBDIVISION PLANS 2000-MID 2004. THE MAP PLACEMENT AND LOCATION IS BASED UPON USGS QUADRANGLES AND SOME GPS MONUMENT LOCATIONS. THEREFORE, SOME DISTORTION IN SCALE AND SHAPE HAS OCCURRED. THIS MAP SHOULD NOT BE USED FOR ANY BOUNDARY OR DEED DESCRIPTIONS.

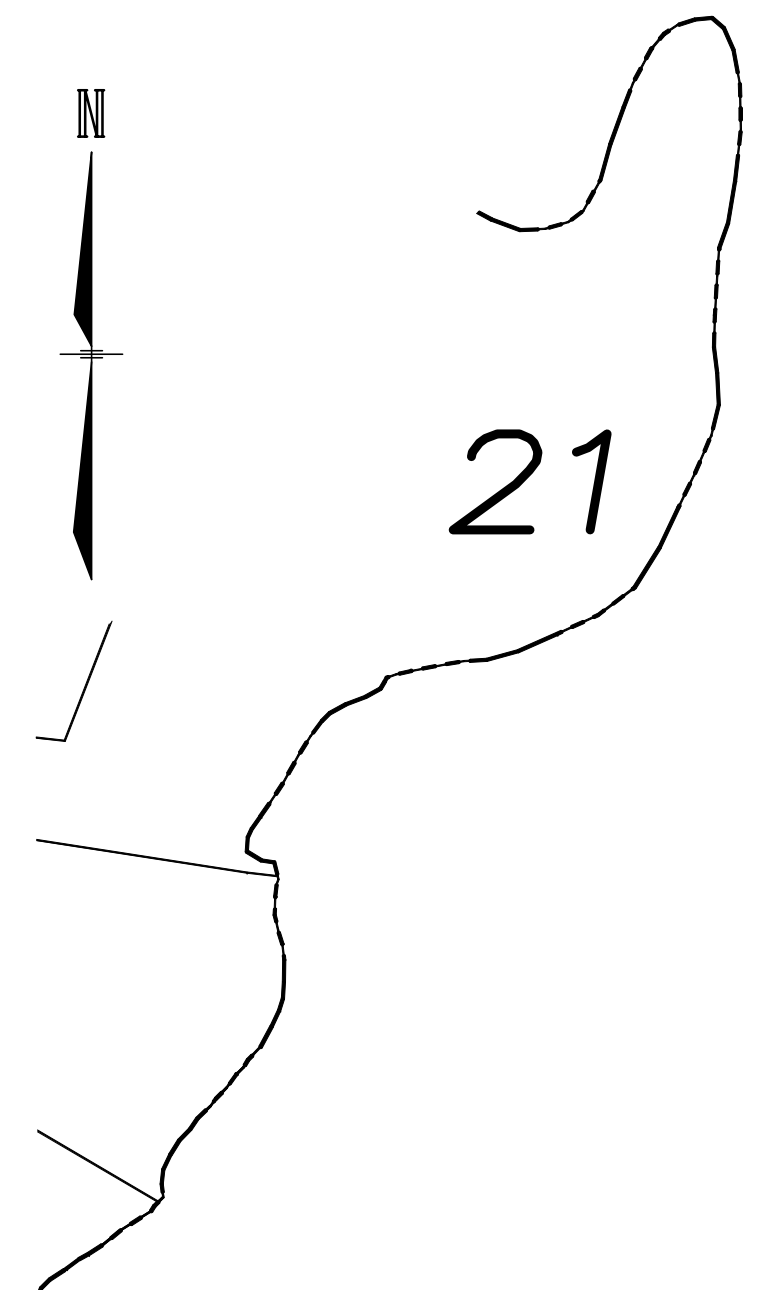
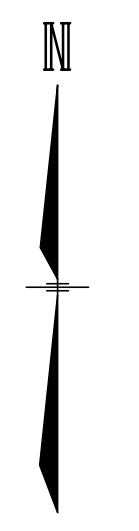

LAKE
MONOMONAC



48 Constitution Drive
Bedford, NH 03043
Phone (603) 472-4488
Fax (603) 472-9747
www.tfmoran.com

Civil Engineers
Structural Engineers
Traffic Engineers
Land Surveyors
Land Planners
Landscape Architects

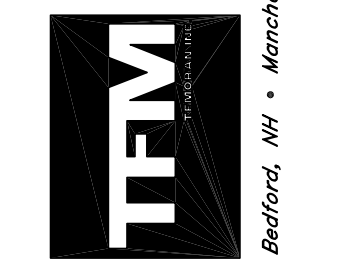

TOWN OF RINDGE
CHESHIRE COUNTY
NEW HAMPSHIRE

DATED: August 2004
REVISED: April 2005
June 2005
CURRENT TO:
APRIL 1, 2014

SCALE: 1"=100'±
CADFILE: 82290 base

PROPERTY
MAP
22